

Plan 7 Purple Martin Gourd Rack

SUPPLIES NEEDED:

LUMBER:

ONE - 2" X 6" X 4' PLANK
 ONE - 2" X 4" X 8'
 TWO - 1" X 4" X 8' BOARDS
 ONE - 4" X 4" X 20' P.T. POLE

OTHER MATERIALS NEEDED:

UP TO SIXTEEN NESTING GOURDS
 TWO 7/16" X 5 - 1/4" SCREW EYES (pulley anchor at top of pole and rope tie off at bottom of pole)
 ONE - 3/8" x 4" SCREW EYE (Rope attachment to bottom of slide)
 ONE - 2" DIAMETER PULLEY
 3" LONG GALVANIZED DECK SCREWS (To assemble "SLIDE")
 1-1/2" LONG GALVANIZED DRYWALL SCREWS (For attaching gourd hangers to "SLIDE")
 16 FEET OF #12 SOLID COPPER WIRE WITH INSULATION (For hanging 16 gourds)
 35 FEET #10 BRAIDED NYLON ROPE (5/16" Dia.) OR BUY A CABLE & WINCH ASSEMBLY
 Two or three 80 lb. BAGS OF PREMIXED CONCRETE

ASSEMBLY INSTRUCTIONS:

- Assemble "SLIDE" with 3" long deck screws. Drill pilot holes as necessary.
- Slide "SLIDE" onto pole making certain there is enough clearance for "SLIDE" to move up and down the pole.
- Attach 7/16" X 5 1/4" SCREW EYE as pulley anchor. Pre-drill post with pilot hole as needed. Spread Eye so that pulley will slide on easily.
- Attach smaller SCREW EYE to bottom of "SLIDE" and the larger about 8" from bottom of post. The "SLIDE" should be located between pulley and lower screw eye on post.
- Tie rope to eye hook on "SLIDE" thread through pulley and down to screw eye on bottom of pole.
- Dig hole 2 1/2 - 3 ft. deep, & 8 - 12 inches in Diameter.
- With help of 2 or 3 people and a rope, plant pole in hole.
- Fill hole with 2 or 3 bags of premixed concrete.
- Provide supports as concrete cures.
- Attach GOURD HANGERS with 1-1/2" galvanized drywall screws.
- Attach GOURD HANGERS with #12 gauge copper wire. The top of the gourd should be about 1/2" below the bottom of hanger.

The gourds must be wired on as illustrated so the "swing plane" of the gourd is FRONT to BACK.

Entrance holes should be oriented away from post and perpendicular to hangers.

- Hoist "SLIDE" assembly to top of pole using rope and pulley. Tie rope off to screw eye at bottom of post.
- Installation of a pole guard is recommended to deter predators.

- Painting or staining assembly will ensure durability. Gourds must be painted white to reflect the sun's rays, keeping the interior cooler. This is important for the vulnerable nestings.

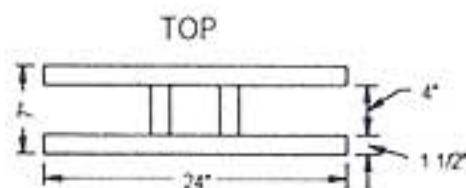

TOP, SIDE & FRONT VIEW OF "SLIDE" WITHOUT GOURD HANGERS.

The "SLIDE" carries the gourds up and down the pole using a rope & pulley system.

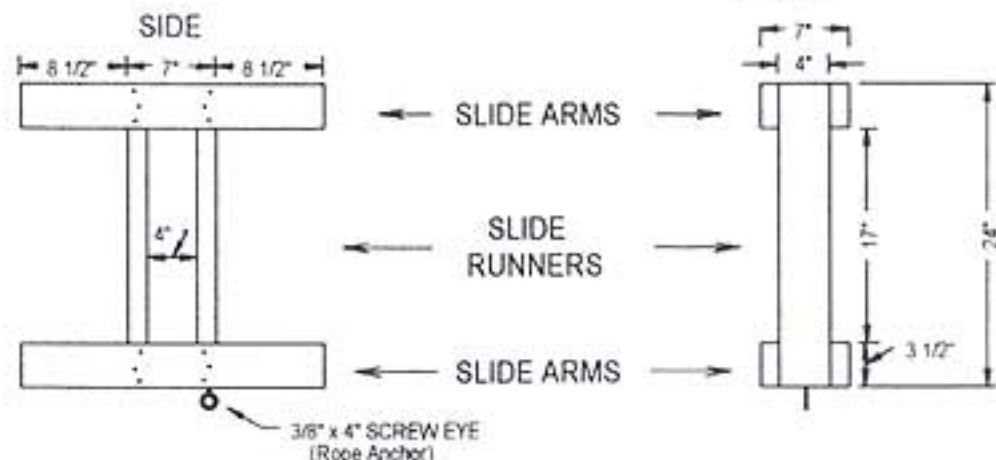

SIDE AND FRONT VIEW OF "SLIDE" WITH GOURD HANGERS AND POLE

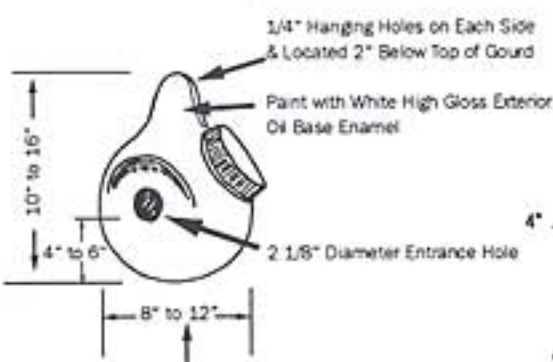
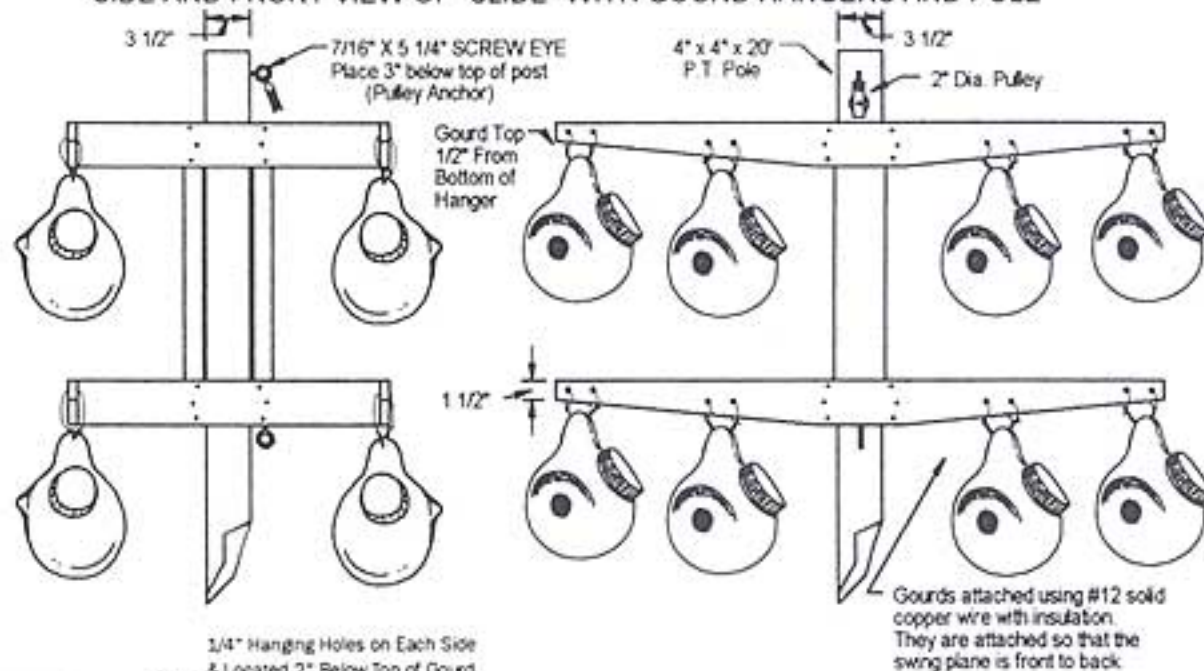

SLIDE RUNNERS
2" X 6" X 4'

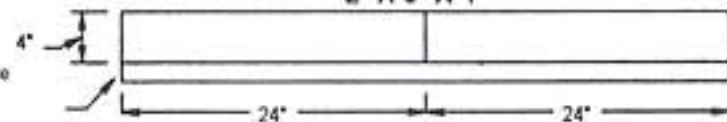

SLIDE ARMS
2" X 4" X 8'

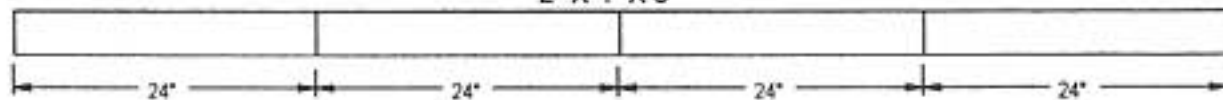

GOURD HANGERS
TWO 1" X 4" X 8' BOARDS

